

Product Dimension Sheet

Japan Mente Corporation
6-5-20 Kuriu, Aoba-ku, Sendai City,
Miyagi Prefecture, JAPAN
TEL+8122-797-9917 FAX+8122-797-9918

Product Name

Bevel Plug

LOT. No

Standard Dimensions

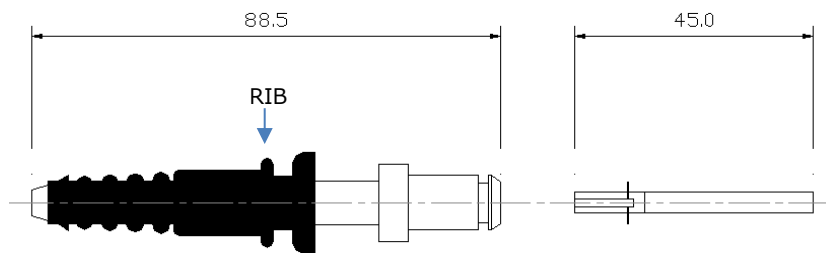

(Figure: Dimensions — 88.5 / 45.0, Rib, Plug Body, Release Pin)

Material

Body: PA66

Grip Section: Olefin-based Thermoplastic Elastomer

Pilot Hole Diameter

10.5 mm (Mist Diamond Drill recommended)

Injection Pressure

0 MPa – 5 MPa (Max)

Note: 5 MPa is the maximum pressure of a manual pump.

HS code : HS 3926.90.99

Product Test Report

Japan Mente Corporation
6-5-20 Kuriu, Aoba-ku, Sendai City,
Miyagi Prefecture, JAPAN
TEL+8122-797-9917 FAX+8122-797-9918

Product Name

Seal Cement SS

LOT.No

Test Results

Test Item		Unit	Measured Value	Standard Value
Compressive Strength	7 days	N/mm ²	35.6	≧30
	28 days		54.2	≧50
Density	Conforms to JIS R 5210	g/cm ³	2.0	2.0±0.1
Setting Time (20 ± 2°C)		min	27	15~45

Remarks: Raw material supplier: Nitta

HS code : HS 3824.50

Product Test Report

Japan Mente Corporation
6-5-20 Kuriu, Aoba-ku, Sendai City,
Miyagi Prefecture, JAPAN
TEL+8122-797-9917 FAX+8122-797-9918

Product name

RestorAID-ONE

LOT.No

Test scores

Test items		unit	Test values	Standard value
consistency	Immediately	seconds	17.6	Within 30
	60 minutes later		16.9	Within 45
Water retention coefficient	(-)	%	44.0	30~65
Compressive strength	28th year of age	N/mm ²	27	15~45

Note: Raw material supplier/Taiheiyo Material

- ◎ The tests were conducted under ambient temperature conditions of $20\pm 2^{\circ}\text{C}$.
- ◎ The test formulation was performed using 3000g of powder and 1400g of water.
- ◎ Consistency conforms to JSCE-K542 (using a P-funnel).
- ◎ The water retention coefficient and compressive strength conform to JSCE-K542.
- ◎ The compressive strength is based on the test results from the previous month.

HS code : HS 3824.99